



DISCOVERY 3

OWNER'S HANDBOOK

Publication Part No. LRL 10 02 53 701

This handbook forms part of the Owner literature supplied with your new vehicle. Left-hand drive and right-hand drive conditions may be shown in the graphics and where information is specific to a particular country, it is indicated as such.

The **Quick start** section is designed to rapidly familiarise the driver with the initial set up and also explain some of the unique features. Please take the time to study the operating instructions with your vehicle as soon as you can.

Important

The information contained in this handbook covers all vehicle derivatives and optional equipment. Some of the options may not be fitted to your vehicle unless they formed part of the original vehicle specification. Therefore some parts of this handbook may not apply to your vehicle. Furthermore, due to printing cycles, it may include descriptions of options before they become generally available.

The information contained in this publication was correct when it went to print. Vehicle design changes may have been made after this handbook was printed. When this occurs a handbook supplement is added to the literature pack. Subsequent updates can be viewed on the Land Rover Internet site at; **www.ownerinfo.landrover.com**.

In the interest of development, the right is reserved to change specifications, design or equipment at any time without notice and without incurring any obligations. This publication, or part thereof, may not be reproduced nor translated without our approval. Errors and omissions excepted.

© Land Rover 2006

All rights reserved.

Published by Land Rover Technical Communications.

Contents

| | | |
|--|-----|--|
| Quick start | | |
| QUICK START | 7 | |
| Filling station information | | |
| FILLING STATION INFORMATION..... | 38 | |
| Introduction | | |
| SYMBOLS GLOSSARY | 40 | |
| LABEL LOCATIONS | 40 | |
| HEALTH AND SAFETY | 41 | |
| DATA RECORDING..... | 41 | |
| PARTS AND ACCESSORIES..... | 42 | |
| Keys and remote controls | | |
| PRINCIPLE OF OPERATION | 44 | |
| GENERAL INFORMATION ON RADIO | | |
| FREQUENCIES | 44 | |
| USING THE KEY | 45 | |
| PROGRAMMING THE REMOTE CONTROL..... | 45 | |
| Locks | | |
| LOCKING AND UNLOCKING..... | 47 | |
| Engine immobiliser | | |
| PRINCIPLE OF OPERATION | 50 | |
| CODED KEYS | 50 | |
| Alarm | | |
| PRINCIPLE OF OPERATION | 51 | |
| ARMING THE ALARM | 51 | |
| SWITCHING OFF THE ALARM..... | 52 | |
| TILT SENSOR..... | 53 | |
| PANIC ALARM | 53 | |
| Seats | | |
| SITTING IN THE CORRECT POSITION | 54 | |
| MANUAL SEATS | 55 | |
| ELECTRIC SEATS..... | 57 | |
| HEAD RESTRAINTS | 58 | |
| REAR SEATS..... | 59 | |
| HEATED SEATS..... | 65 | |
| Seat belts | | |
| GENERAL INFORMATION | 66 | |
| SEAT BELT REMINDER..... | 68 | |
| FASTENING THE SEAT BELTS | 68 | |
| SEAT BELT HEIGHT ADJUSTMENT..... | 69 | |
| | | USING SEAT BELTS DURING PREGNANCY.... 69 |
| Airbags | | |
| PRINCIPLE OF OPERATION..... | 70 | |
| SIDE AIRBAGS | 72 | |
| CURTAIN AIRBAGS | 72 | |
| DISABLING THE PASSENGER AIRBAG..... | 73 | |
| AIRBAG WARNING LAMP | 75 | |
| AIRBAG SERVICE INFORMATION..... | 75 | |
| Child safety | | |
| CHILD SEATS | 76 | |
| CHILD SEAT POSITIONING | 78 | |
| ISOFIX ANCHOR POINTS..... | 80 | |
| CHILD SAFETY LOCKS | 82 | |
| Steering wheel | | |
| ADJUSTING THE STEERING WHEEL | 83 | |
| HORN | 83 | |
| AUDIO CONTROL | 83 | |
| VOICE CONTROL | 84 | |
| CRUISE CONTROL..... | 84 | |
| Lighting | | |
| GENERAL INFORMATION | 85 | |
| LIGHTING CONTROL | 86 | |
| FRONT FOG LAMPS..... | 87 | |
| REAR FOG LAMPS..... | 87 | |
| ADJUSTING THE HEADLAMPS..... | 88 | |
| HEADLAMP LEVELLING | 88 | |
| HAZARD WARNING FLASHERS..... | 89 | |
| ADAPTIVE FRONT LIGHTING SYSTEM (AFS) . | 89 | |
| DIRECTION INDICATORS | 91 | |
| INTERIOR LAMPS | 92 | |
| REMOVING A HEADLAMP | 93 | |
| REMOVING A REAR LAMP | 94 | |
| CHANGING A BULB | 95 | |
| BULB SPECIFICATION CHART | 104 | |
| Wipers and washers | | |
| WINDSCREEN WIPERS | 105 | |
| RAIN SENSOR | 106 | |
| WINDSCREEN WASHERS..... | 106 | |
| REAR WINDOW WIPER AND WASHERS..... | 107 | |
| ADJUSTING THE WINDSCREEN WASHER JETS . | 108 | |
| HEADLAMP WASHERS..... | 108 | |

Contents

| | | | |
|-------------------------------------|-----|------------------------------------|-----|
| CHECKING THE WIPER BLADES | 108 | TRANSFER GEARBOX | 148 |
| CHANGING THE WIPER BLADES..... | 109 | | |
| Windows and mirrors | | Brakes | |
| ELECTRIC WINDOWS..... | 110 | PRINCIPLE OF OPERATION | 152 |
| EXTERIOR MIRRORS | 111 | HINTS ON DRIVING WITH ABS..... | 154 |
| ELECTRIC EXTERIOR MIRRORS | 112 | ELECTRIC PARKING BRAKE (EPB) | 155 |
| INTERIOR MIRROR | 114 | | |
| Information displays | | Parking aid | |
| TRIP COMPUTER | 115 | PRINCIPLE OF OPERATION | 159 |
| PERSONALISED SETTINGS..... | 116 | USING THE PARKING AID..... | 159 |
| INFORMATION MESSAGES..... | 117 | | |
| Climate control | | Driving hints | |
| AIR VENTS | 119 | RUNNING-IN | 161 |
| MANUAL CLIMATE CONTROL | 121 | GENERAL DRIVING POINTS..... | 161 |
| AUTOMATIC CLIMATE CONTROL..... | 123 | REDUCED ENGINE PERFORMANCE..... | 163 |
| REAR PASSENGER CLIMATE CONTROLS.... | 126 | ECONOMICAL DRIVING | 163 |
| HEATED WINDOWS AND MIRRORS | 126 | | |
| AUXILIARY HEATER | 127 | Cruise control | |
| ELECTRIC SUNROOF..... | 127 | PRINCIPLE OF OPERATION | 164 |
| | | USING CRUISE CONTROL..... | 164 |
| Convenience features | | Stability control | |
| SUN VISORS | 129 | PRINCIPLE OF OPERATION | 166 |
| SUN BLINDS..... | 129 | USING STABILITY CONTROL..... | 166 |
| INSTRUMENT LIGHTING DIMMER..... | 129 | | |
| CLOCK..... | 130 | Traction control | |
| CIGAR LIGHTER | 132 | PRINCIPLE OF OPERATION | 168 |
| ASHTRAY | 132 | | |
| AUXILIARY POWER SOCKETS | 133 | Hill descent control (HDC) | |
| CUP HOLDERS | 134 | PRINCIPLE OF OPERATION | 169 |
| CENTRE CONSOLE | 135 | USING HDC..... | 169 |
| COOL BOX | 136 | | |
| STORAGE COMPARTMENTS..... | 137 | Terrain response | |
| MEMORY FUNCTION..... | 138 | PRINCIPLE OF OPERATION | 172 |
| | | USING TERRAIN RESPONSE | 172 |
| Starting the engine | | Air suspension | |
| GENERAL INFORMATION | 139 | PRINCIPLE OF OPERATION | 179 |
| STARTER SWITCH | 139 | ADJUSTING THE SUSPENSION | 180 |
| STEERING WHEEL LOCK..... | 140 | AIR SUSPENSION MESSAGES..... | 184 |
| STARTING A PETROL ENGINE | 140 | | |
| STARTING A DIESEL ENGINE..... | 141 | Fuel and refuelling | |
| | | SAFETY PRECAUTIONS..... | 186 |
| Transmission | | FUEL QUALITY | 186 |
| MANUAL TRANSMISSION..... | 142 | RUNNING OUT OF FUEL..... | 188 |
| AUTOMATIC TRANSMISSION | 142 | FUEL FILLER FLAP | 189 |
| | | REFUELLING | 190 |

Contents

| | | | |
|--------------------------------------|-----|--|-----|
| FUEL CUT-OFF | 191 | TYRE PRESSURE MONITORING SYSTEM.... | 248 |
| CATALYTIC CONVERTER | 191 | TYRE GLOSSARY | 253 |
| FUEL CONSUMPTION | 192 | | |
| Load carrying | | Fuses | |
| GENERAL INFORMATION | 193 | FUSE BOX LOCATIONS..... | 254 |
| LUGGAGE ANCHOR POINTS..... | 193 | CHANGING A FUSE..... | 255 |
| REAR LOADSPACE HATCHES..... | 193 | FUSE SPECIFICATION CHART | 257 |
| LUGGAGE COVERS | 194 | | |
| Towing | | Vehicle recovery | |
| TOWING A TRAILER | 197 | TOWING POINTS..... | 263 |
| GEAR CHANGING..... | 198 | LASHING POINTS..... | 264 |
| LEVELLING | 198 | TRANSPORTING THE VEHICLE | 265 |
| ESSENTIAL TOWING CHECKS | 199 | TOWING THE VEHICLE ON FOUR WHEELS.. | 265 |
| RECOMMENDED TOWING WEIGHTS | 200 | | |
| DETACHABLE TOW BALL | 200 | Vehicle identification | |
| TOW BAR DIMENSIONS | 204 | VEHICLE IDENTIFICATION NUMBER (VIN)... | 267 |
| | | Technical specifications | |
| Vehicle care | | TECHNICAL SPECIFICATIONS | 268 |
| CLEANING THE EXTERIOR | 207 | | |
| CLEANING THE INTERIOR | 208 | Type approvals | |
| REPAIRING MINOR PAINT DAMAGE | 209 | TYPE APPROVALS | 274 |
| | | Audio introduction | |
| Maintenance | | RADIO RECEPTION..... | 283 |
| GENERAL INFORMATION | 210 | | |
| OPENING AND CLOSING THE BONNET | 212 | Audio unit overview | |
| ENGINE COMPARTMENT OVERVIEW | 213 | AUDIO UNIT OVERVIEW..... | 284 |
| UNDER BONNET COVERS..... | 219 | | |
| ENGINE OIL CHECK | 219 | Audio unit operation | |
| ENGINE COOLANT CHECK | 220 | ON/OFF CONTROL | 286 |
| BRAKE FLUID CHECK | 222 | VOLUME CONTROL | 286 |
| POWER STEERING FLUID CHECK | 223 | BASS/TREBLE CONTROL | 289 |
| WASHER FLUID CHECK..... | 224 | BALANCE/FADE CONTROL | 292 |
| | | STATION PRESET BUTTONS | 292 |
| Vehicle battery | | WAVEBAND BUTTON | 293 |
| BATTERY WARNING SYMBOLS | 225 | AUTOSTORE CONTROL | 293 |
| BATTERY CARE | 225 | RADIO DATA SYSTEM (RDS) | 294 |
| USING BOOSTER CABLES | 226 | TRAFFIC INFORMATION (TA) CONTROL | 295 |
| CHARGING THE VEHICLE BATTERY | 228 | PTY PROGRAMME TYPES..... | 297 |
| CHANGING THE VEHICLE BATTERY | 229 | | |
| | | Compact disc player | |
| Wheels and tyres | | LOADING COMPACT DISCS | 299 |
| GENERAL INFORMATION | 230 | EJECTING COMPACT DISCS | 301 |
| CHANGING A ROAD WHEEL | 231 | EJECTING MULTIPLE COMPACT DISCS..... | 301 |
| TYRE CARE | 242 | COMPACT DISC SELECTION | 302 |
| USING SNOW CHAINS..... | 248 | COMPACT DISC PLAYBACK | 303 |

Contents

| | |
|--|-----|
| TRACK SELECTION..... | 304 |
| COMPACT DISC PAUSE..... | 304 |
| FAST FORWARD/REVERSE | 304 |
| COMPACT DISC FUNCTION MENU..... | 305 |
| SHUFFLE/RANDOM | 305 |
| REPEAT COMPACT DISC TRACKS | 306 |
| COMPACT DISC TRACK SCANNING | 306 |
| MP3 FILE PLAYBACK | 307 |
| Rear passenger controls | |
| REAR SEAT CONTROLS | 308 |
| HEADPHONES | 309 |
| Auxiliary input (AUX IN) socket | |
| AUXILIARY INPUT (AUX IN) SOCKET..... | 310 |
| Voice recognition | |
| PRINCIPLE OF OPERATION..... | 312 |
| USING THE SYSTEM | 312 |
| AUDIO SYSTEM COMMANDS | 314 |

Quick start

QUICK START

Remote control

Dependent upon specification and vehicle configuration, the operation of the remote control may differ from the following.

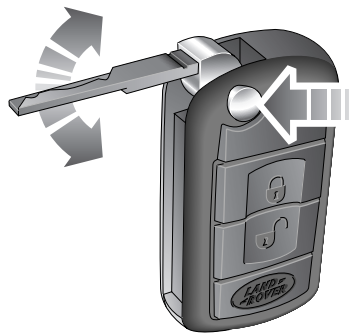

0604



Press once to lock all doors and arm the alarm.

Press twice within three seconds to deactivate the interior space protection and tilt sensor.



Press once to deactivate the alarm and unlock the driver's door (**Single point entry**).

A second press will unlock all other doors.



Customer configurable button. Can be programmed to remotely operate one of the following functions:

- Headlamp on (default).
- Panic alarm.
- Air suspension.

See **PROGRAMMING THE REMOTE CONTROL** (page 45).

Single point entry

This is a security feature that unlocks only the driver's door. It can be disabled on individual remote controls by simultaneously pressing and holding the lock and unlock buttons for three seconds. The vehicle will lock and then unlock in the currently selected mode to confirm the change.

You can now unlock all doors with a single press. Repeating the procedure will re-enable Single point entry.

Automatic relock

If the vehicle is unlocked with the remote control, it will automatically relock and arm the alarm if a door or the tailgate is not opened within one minute.

Key blade

Press button (arrowed in illustration) to release the key blade.

Remote control battery

The remote control battery is rechargeable and should never need replacement. The battery is recharged whenever the key is in the starter switch and the engine running.

Quick start

Central locking

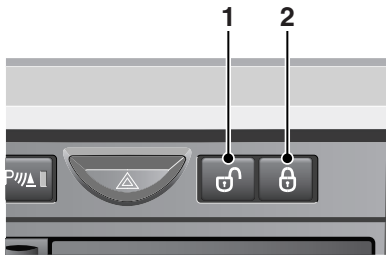

LAN0605

Master lock and unlock switches

1. Press to unlock all doors and tailgate.
2. Press to lock all doors and tailgate.

Speed-related locking

If enabled, the doors and tailgate will automatically lock when the vehicle's speed exceeds 8 km/h (5 mph).

This feature can be disabled or enabled in the Settings option accessed via the trip computer.

Tailgate

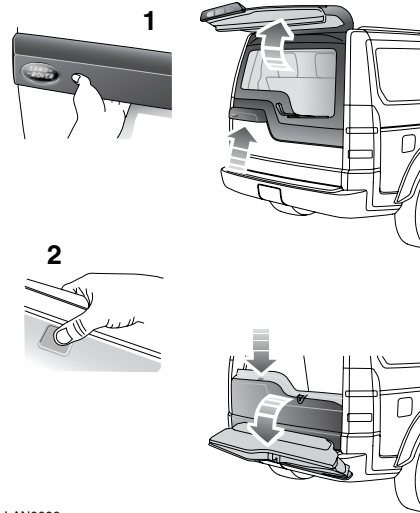

LAN0606

Opening the upper tailgate

With all the doors unlocked, press the release switch 1 on the underside of the exterior handle and pull to open.

Opening the lower tailgate

With the upper tailgate open, press the touch pad 2 on the lower tailgate waist moulding.

Operating note

If the tailgate is locked/unlocked 10 times within a short period, the latch will be disabled for approximately one minute, to protect the battery and lock mechanism.

Quick start

Bonnet

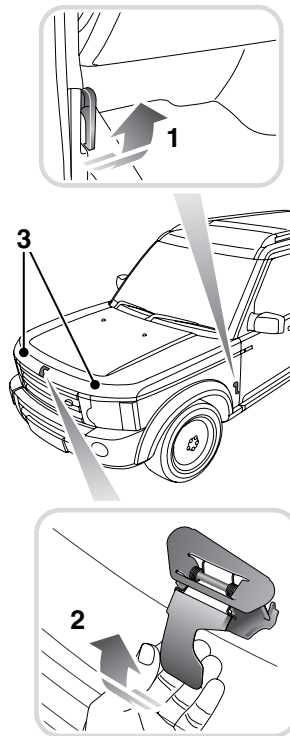

LAN0607

Opening

Pull the bonnet release lever **1** located on the left-hand side of the vehicle.

Lift the bonnet safety catch lever **2**, located on the front edge of the hood beneath the centre point of the words LAND ROVER, and raise the bonnet.

Closing

Lower the bonnet until the safety catch engages. Using both hands, press the bonnet down until the catches click.

Check that both catches **3** are engaged by trying to lift the front edge of the bonnet.

Power operated seat adjustment

To adjust the seats the starter switch must be in position **I** or **II**. On those vehicles equipped with a memory driver's seat, the seat has a 10 minute active period initiated when the driver's door is opened/closed or the starter key is turned to the off position.



LAN0611

1. Seat forward/backward, cushion height and front tilt control switch.
2. Backrest adjustment switch.
3. Lower backrest lumbar support handwheel.

Quick start

Driving position memory (when fitted)

Once you have adjusted the power operated driver's seat and exterior mirrors for your ideal driving position, the vehicle can memorise these settings for future use.

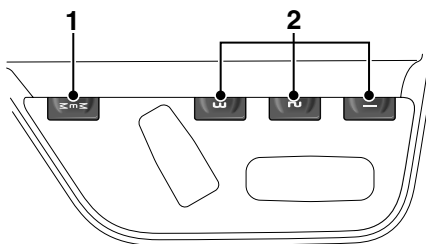

LAN0612

1. Press the memory store button **1** to activate the memory function for five seconds.
2. Press one of the preset buttons **2** within five seconds to memorise the current settings.

Memory Stored will be displayed on the message centre accompanied by an audible chime to confirm the settings have been memorised.

Operating note

A seat position will only be memorised during the five second active period.
Any existing settings will be over-written when programming a memory position.

Lazy entry

When this feature is enabled, the vehicle stores the seating and mirror positions for each remote control. Next time the vehicle is unlocked using a remote control, the position of the seat and mirrors will adjust to the last used position.

This feature can be disabled or enabled in the Settings option accessed via the trip computer.

Manual seat adjustment

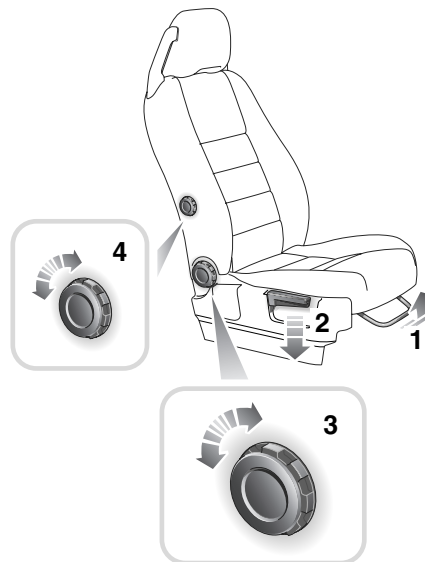

LAN0613

1. Forward/backward adjustment.
2. Height adjustment.
3. Backrest adjustment.
4. Lower backrest lumbar support.

Quick start

Windows/Door mirrors

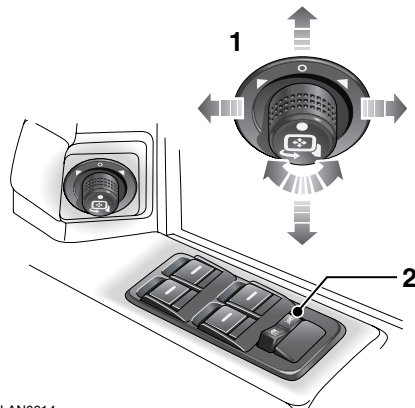

LAN0614

- To open a window, press and hold the respective switch.
- To close the window, pull and hold the switch.
- Window movement can be stopped at any time by releasing the switch.

The driver's window has a one touch facility that allows it to be fully opened or closed with a single operation of the switch. Firmly press the switch and release. Movement can be stopped by briefly pressing the switch again.

Press the right-hand side of switch **2** to inhibit the operation of the rear window switches.

Resonance with lowered windows

If a resonance/booming sound occurs when a rear window is open, lowering an adjacent front window about 25 mm (1 inch) will eliminate the condition.

Door mirror adjustment

To adjust the mirrors, rotate the mirror adjustment knob **1** left or right to select the appropriate mirror. Move the knob in any direction to adjust the position of the mirror glass.

Power fold mirrors (when fitted)

Some vehicles are equipped with the facility that allows the mirrors to be electrically folded towards the door for better clearance/protection.

With the mirror adjustment switch knob in the central position, push the knob downwards to fold/unfold the mirrors.

Reverse automatic mirror dip

With the feature enabled, when reverse gear is selected the door mirrors will dip.

The dip position of the door mirrors can be personalised. See **ELECTRIC EXTERIOR MIRRORS** (page 112).

This feature can be disabled or enabled in the **Settings** option accessed via the trip computer. See **TRIP COMPUTER** (page 115).

Quick start

Steering column adjustment

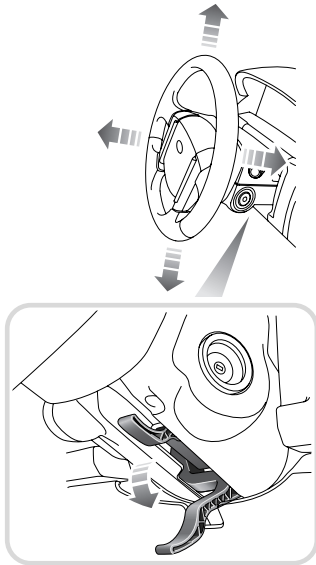

LAN0615

1. Move the lever located under the steering wheel fully downward.
2. Adjust the height and reach of the steering wheel to the desired position.
3. Move the lever fully up to lock the position of the wheel.

Overhead console

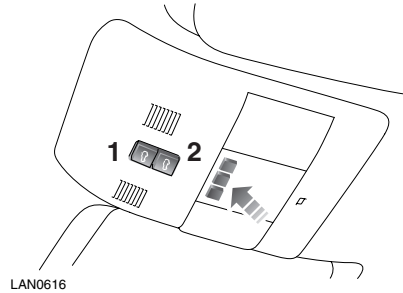

LAN0616

Courtesy lamps

If automatic mode is enabled, the front and rear courtesy lamps will operate in conjunction with the vehicle being unlocked/locked or when a door is opened.

The courtesy lamps can be manually switched on/off by pressing and releasing the centre lamp switch (arrowed in illustration).

Automatic mode

Automatic mode for the courtesy lamps can be enabled/disabled by pressing and holding the centre lamp switch for more than three seconds.

A message will be displayed in the message centre advising you of the currently set mode.

Interior lamps

The interior lamps can be switched on/off by pressing the switch adjacent to the lamp.

Quick start

Sunroof

To open the sunroof:

- Press and release the rear of the switch **1** to open the roof to the tilt position.
- Press and release the rear of the switch again to open the roof fully.

To close the sunroof:

- Press and release the front of the switch **2** to close the roof to the tilt position.
- Press and hold the front of the switch again to close the roof fully.

If the sunroof is moving, it can be stopped by pressing the switch again.

Operating note

The sunroof can be operated with the starter key in position **I** or **II** and for 40 seconds after position **0** has been selected, providing that neither front door has been opened.

With the starter key in position **I** or **0**, the switch will need to be pressed and held until the roof reaches the desired position.

Rear view mirror

Some rear view mirrors are fitted with a feature that will automatically darken to counteract glare from the headlamps of a following vehicle.

This feature is temporarily switched off when reverse gear is selected.

Seat belts/Child restraints

The use of front and rear seat belts is mandatory in most countries. **Using seat belts saves lives.** They should be worn by all occupants whenever the vehicle is in use.



A warning light on the instrument pack will illuminate to alert you that the driver's and/or front

passenger's seat belt is unbuckled. Dependent upon specification this may be accompanied by an intermittent chime.

Automatic Locking Reels (ALR)

The second and third row seat belts have ALR fitted for use with child seats or securing large items.

- To engage: Extend belt to maximum length to enable locking mechanism.
- Allow seat belt to retract onto the child seat/item (a clicking sound will be heard as the belt retracts). Ensure there is no slack by pressing the seat/item firmly into the vehicle seat.
- To disengage: Unbuckle belt and allow belt to fully retract.

With ALR enabled, as the seat belt retracts, it will automatically lock preventing re-extension.

Ensure passengers do not fully extend the restraints and inadvertently engage this feature during normal use.

Quick start

Child Seats

It is important to remember that the child's weight, rather than age, determines the type of seat that is required. See **CHILD SEATS** (page 76).

Recommended child seat

Land Rover strongly recommends the use of ISOFIX child seats. ISOFIX child seats can only be fitted in the second-row outer seating positions.

Passenger airbag deactivation



LAN0617

If it becomes necessary to fit a child restraint on the front passenger seat, the passenger airbag must be deactivated.

To deactivate the airbag, open the front passenger door and use the starter key to turn the **PASS.AIRBAG** switch (located on the end of the fascia) to the **OFF** position.

With the airbag deactivated, the status indicator (arrowed in illustration) will illuminate whenever the starter key is turned to position **II**.

Operating note

When an adult is seated in the front passenger seat, ensure the **PASS.AIRBAG** switch is turned to the **ON** position.

Quick start

Heating and ventilation

These are the primary functions of the heating and ventilation system. Dependent upon specification, the control panel may differ from those shown.

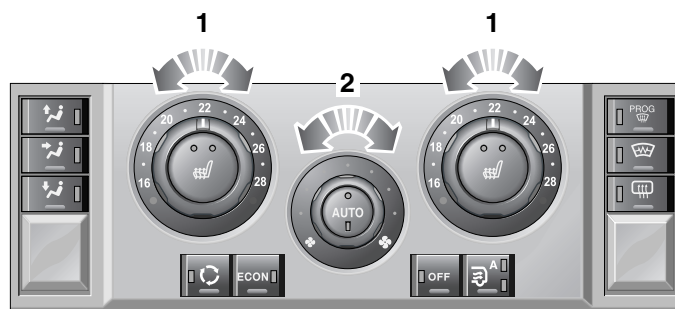

LAN0618

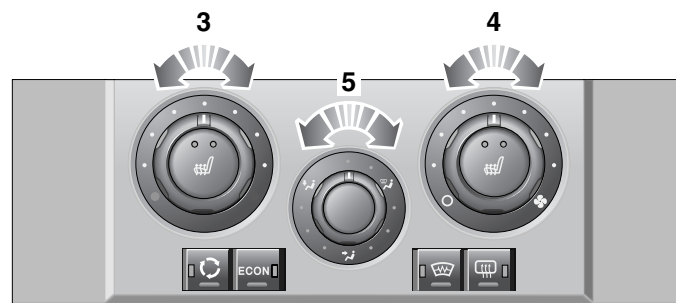

LAN0619

Air conditioning

Air conditioning is an integral part of the heating and ventilation system, providing cooled and dehumidified air for occupant comfort. The dry airflow is effective in preventing misting of windows and is also beneficial at low external temperatures.

Air conditioning is automatically switched on and controlled whenever the system is not operating in economy mode.

Quick start

External water deposits

The air conditioning system removes moisture from the air and deposits excess water beneath the vehicle. Puddles may form, but this is normal and no cause of concern.

AUTO mode (Automatic system only)



Press **AUTO** to select automatic operation of the system, both LEDs in the switch will illuminate.

The system will adjust the heat output, blower speed, air intake and airflow distribution to maintain the selected temperature(s) and reduce misting without further adjustments.

The air distribution and blower controls can be operated to override the automatic settings. This will extinguish the appropriate LED in the **AUTO** control.

Recommended mode

Select **AUTO** as the normal operating mode. This will help prevent window misting and odours from the climate control system.

Temperature selection (Automatic system only)

Rotate the controls **1** to adjust the temperature for the respective side of the passenger compartment.

Operating note

On the automatic system, it is not possible to achieve a temperature differential of more than 4°C (7°F) between the left and right.

Blower speed (Automatic system only)

Rotate the blower control **2** to adjust airflow through the vents. As the control is adjusted, LEDs will illuminate to indicate which of the eight possible speeds is currently selected.

Air distribution control (Automatic system only)

Press to select the desired distribution setting. An LED will illuminate in the switch.



Windscreen and side window vents



Face level vents



Foot level vents

More than one setting can be selected to achieve the desired distribution.

OFF (Automatic system only)



Press to switch the system off. An LED will illuminate in the switch to show this condition.

Press again to return the system to its previous operating mode. The system will also be reactivated by using the **AUTO**, blower speed, air distribution or defrost controls.

Defrost mode (Automatic system only)



Press to remove frost or heavy misting from the windscreen. The system will automatically adjust the

blower output for maximum clearing, in addition the rear window and windscreen heaters will be activated.

Press again to switch off defrost mode. The rear screen and windscreen heaters will remain on.

Air recirculation



Press once to activate air recirculation. An LED will illuminate in the switch.

Press again to return to fresh air intake.

Quick start

Economy mode



Press button to put the system into economy mode. An LED will illuminate in the switch to show this condition.

In economy mode air conditioning is switched off. This reduces the load on the engine, thereby improving fuel consumption.

Heated windscreen/rear window



Press to operate. An LED in the switch will illuminate whilst operating.



The heaters will automatically switch off after a preset interval.

Seat heaters



Press the relevant button to operate the required seat heater at high level. Both LEDs will illuminate.

Press a second time to heat the seat at a lower level. One LED will extinguish.

Press a third time to switch off.

Temperature selection (Manual system only)

Rotate the control **3** to adjust the air temperature entering the passenger compartment.

Blower speed (Manual system only)

Rotate the blower control **4** to adjust airflow through the vents. As the control is adjusted, LEDs will illuminate to indicate which of the eight possible speeds is currently selected.

Air distribution control (Manual system only)

Rotate the control **5** to achieve the desired air distribution setting.



Windscreen and side window vents



Face level vents



Foot level vents

Rear environment (when fitted)



Press once to activate automatic mode in which the comfort level for the rear passengers is controlled from the front. The upper LED will be illuminated.

Press a second time to pass control of the rear environment to the rear passengers control panel. The lower LED will be illuminated.

Press a third time to switch this feature off. Neither LED will be illuminated.

Quick start

Facia - Left-hand drive vehicles

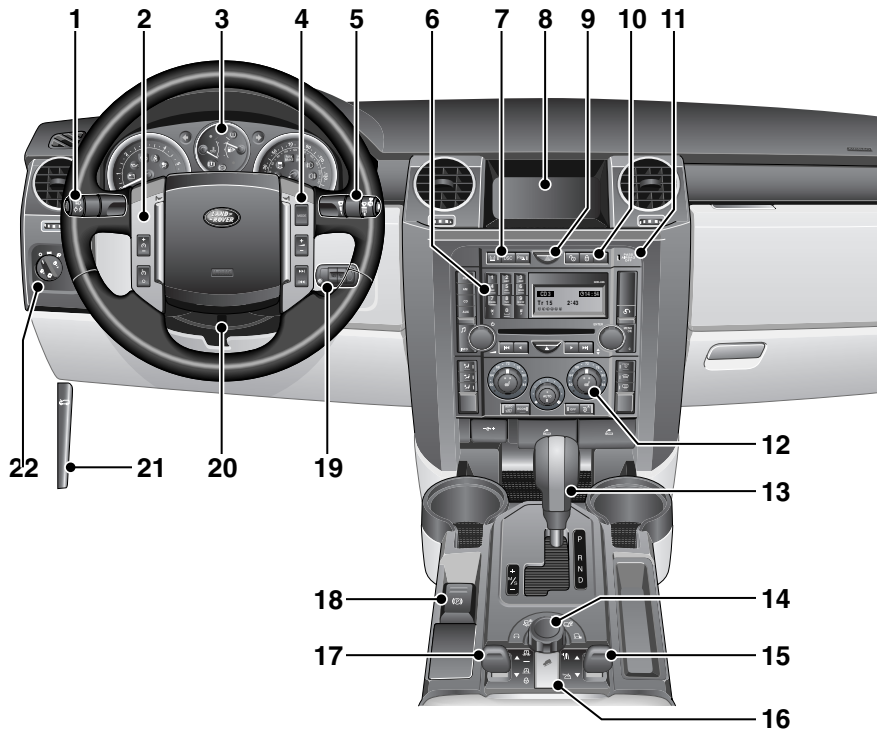

LAN0636

Quick start

1. Direction indicators/headlamps/trip computer switch
2. Cruise control switches
3. Instrument pack/warning indicators and message centre
4. Audio/telephone switches
5. Wiper/washer switch
6. Audio system
7. Dynamic stability control (DSC) switch
8. Touch screen
9. Hazard warning switch
10. Master locking switches
11. Passenger airbag status indicator
12. Heater/air conditioning controls
13. Gear selector
14. Terrain response control switch
15. Transfer gearbox switch
16. Hill Descent Control switch
17. Air suspension control
18. Electric Parking Brake (EPB)
19. Starter switch
20. Steering column adjustment
21. Bonnet release lever
22. Exterior lamps master switch

L

Quick start

Facia - Right-hand drive vehicles

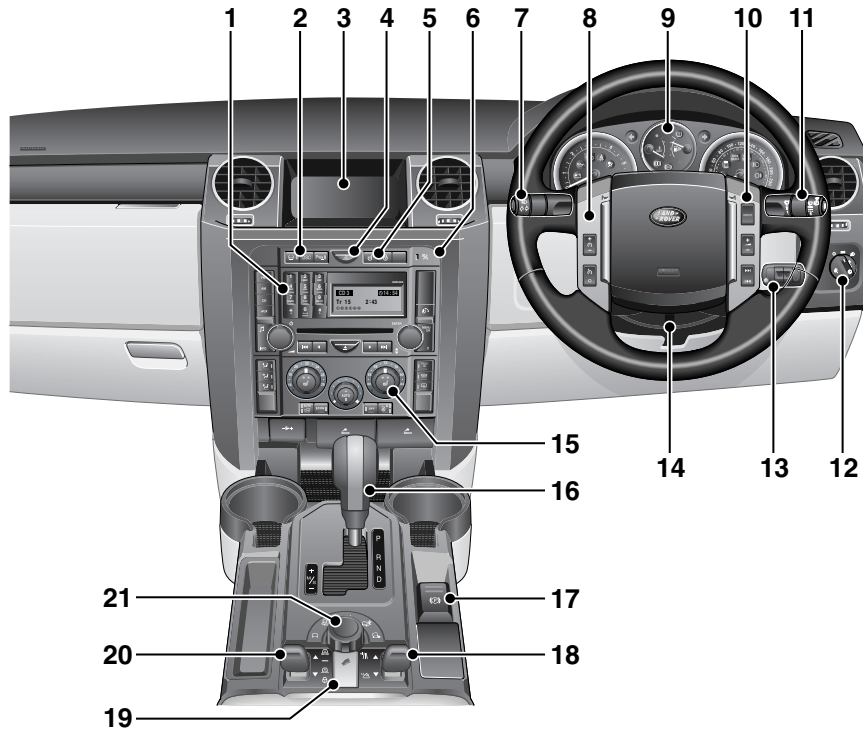

LAN0635

Quick start

1. Audio system
2. Dynamic stability control (DSC) switch
3. Touch screen
4. Hazard warning switch
5. Master locking switches
6. Passenger airbag status indicator
7. Direction indicators/headlamps/trip computer switch
8. Cruise control switches
9. Instrument pack/warning indicators and message centre
10. Audio/telephone switches
11. Wiper/washer switch
12. Exterior lamps master switch
13. Starter switch
14. Steering column adjustment
15. Heater/air conditioning controls
16. Gear selector
17. Electric Parking Brake (EPB)
18. Transfer gearbox switch
19. Hill Descent Control switch
20. Air suspension control
21. Terrain response control switch

Quick start

Instrument pack

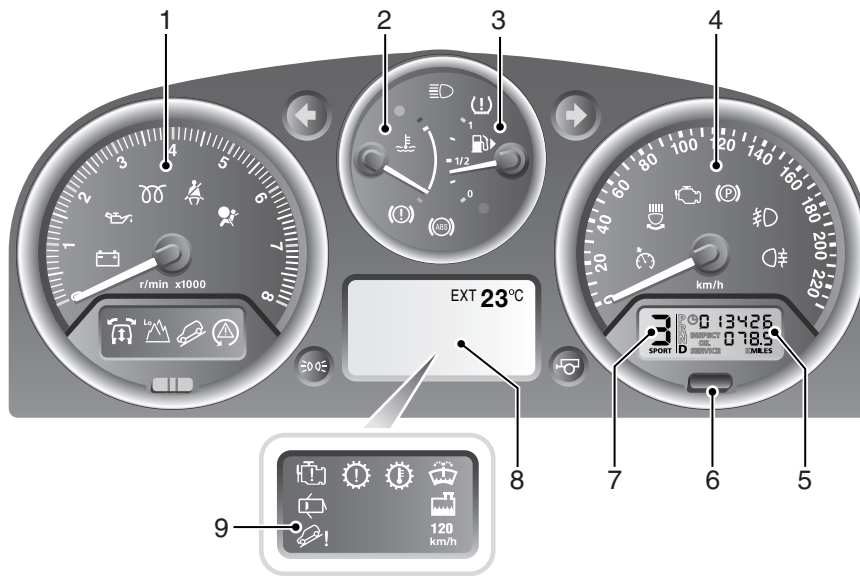

E80508

- | | |
|--|---|
| <ol style="list-style-type: none"> 1. Tachometer 2. Temperature gauge 3. Fuel gauge 4. Speedometer 5. Total distance (odometer) and trip recorder | <ol style="list-style-type: none"> 6. Trip recorder reset switch 7. Gear selector position display 8. Main message centre. 9. Warning indicators panel. |
|--|---|

Quick start

Tachometer

Indicates engine speed in revolutions per minute (x 1 000). In normal driving conditions the engine is most fuel efficient between 2 000 and 3 000 rev/min.

Temperature gauge

At normal operating temperature, the pointer is positioned midway between the red and blue segments of the gauge (the precise position will vary according to climatic conditions).

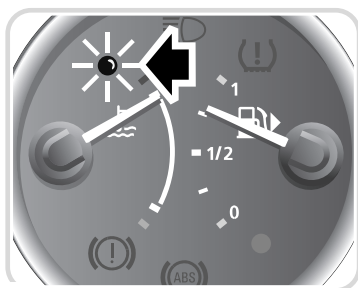

E80509

If the pointer moves above the mid point, the engine coolant is becoming too hot. Should the pointer move into the red segment and the red warning indicator (arrowed) illuminates, severe engine damage could occur (under these circumstances the air conditioning may switch off and engine performance may reduce to minimise engine load).

Stop the vehicle as soon as safety permits, and allow the engine to idle until the warning indicator extinguishes and the pointer moves back to its normal position. If the problem persists, seek qualified assistance immediately.

Fuel gauge

CAUTION

! Never allow vehicles to run out of fuel as the resultant misfire may destroy the catalytic converter.

When the starter switch is turned to position II, the pointer quickly rises to show the level of fuel in the tank.



E80510

When the remaining fuel reaches a minimum of 12 litres (3 gallons), the amber low fuel warning indicator (arrowed) illuminates.

The remaining fuel should give a range of 80 km (50 miles).

The small arrow alongside the fuel pump symbol indicates the side of the vehicle on which the fuel filler is located.

Total distance (odometer) and trip recorder

Indicates the total distance travelled, and also shows the most recent individual journey distance.

Trip recorder reset switch

With the starter switch in position II, press to reset the trip recorder back to zero.

















Selected gear display

The currently selected gear is displayed.

Quick start















Warning indicators (attention)

If any of the following illuminates whilst driving a fault has been detected. Refer to Owner's Handbook for further information.

| | |
|---|---|
|  | Battery charge indicator. See page 161. |
|  | Low oil pressure. See page 161. |
|  | Electric parking brake. See page 155. |
|  | Brake systems. See page 152. |
|  | Anti-lock Braking System. See page 154. |
|  | Airbag system. See page 75. |
|  | Engine management system. See page 163. |
|  | Engine. See page 163. |
|  | Suspension system. See page 179. |
|  | Transmission. See page 142. |
|  | Transmission temperature. See page 142. |
|  | Hill Descent Control (HDC). See page 169. |
|  | Low engine coolant level. See page 220. |
|  | Dynamic Stability Control (DSC). See page 166. |
|  | Adaptive front lighting system. See page 89. |
|  | Tyre Pressure Monitoring system. See page 248. |

Warning indicators (information)

The following will illuminate during normal driving to indicate that a particular system or feature is operating.

| | |
|---|---|
|  | Seat belt reminder. See page 68. |
|  | Door open. See page 47. |
|  | Low screen washer level. See page 224. |
|  | Diesel glow plugs active. See page 141. |
|  | Lo gear range selected. See page 148. |
|  | Hill Descent Control (HDC) active. See page 169. |
|  | Cruise control active. See page 164. |
|  | Direction indicator. See page 91. |
|  | Trailer direction indicator. See page 197. |
|  | Headlamp high beam on. See page 86. |
|  | Sidelamps on. See page 86. |
|  | Rear fog lamps on. See page 87. |
|  | Front fog lamps on. See page 87. |
|  | Overspeed warning. See page 161. |

Quick start

Steering column levers

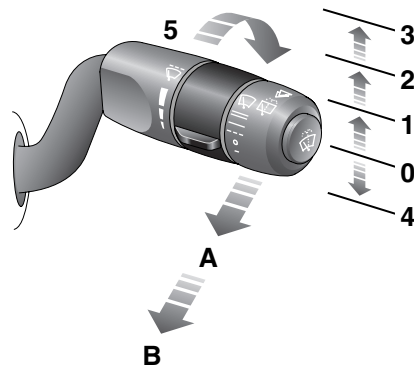

LAN0637

Windscreen wiper

1. Intermittent wipe/rain sensor
2. Normal speed operation
3. High speed operation
4. Single wipe - press and release to operate.

Rotate collar **5** to adjust speed of intermittent wipe or sensitivity of the rain sensor.



Short delay/Most sensitive to rain.

Long delay/Least sensitive to rain.

Windscreen washer



Push the button on the end of the lever to operate the windscreen washer.

Rear wiper and washer

Pull the lever to position **A** for intermittent operation of the rear wiper. Pull and hold the lever in position **B** to operate the rear washer and wiper.

Direction indicators/Headlamp high beam

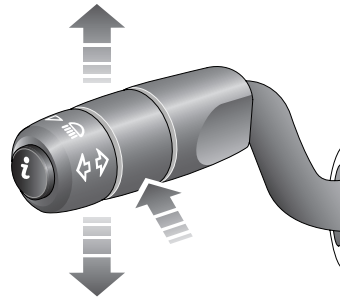

LAN0640



Move the lever up or down to activate the direction indicators.

Moving the lever up or down against spring pressure and then releasing will flash the indicators 3 times. Useful for lane changing.



Push the lever away from you to select headlamp high beam. A warning indicator will illuminate on the instrument panel.

Trip computer



Press the button on the end of the lever to cycle through the trip computer functions displayed on the message centre.

Quick start

Exterior lamps master switch

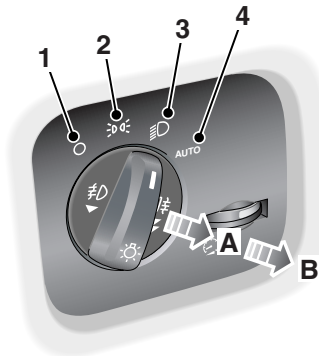

LAN0642

1. Exterior lamps off
2. Sidelamps
3. Headlamps
4. Autolamps

In **AUTO** mode and the starter switch in position **II**, a sensor monitors the exterior light levels and will automatically switch the side lamps and dipped headlamps on and off as required.

- A.** Front fog lamps (if fitted)
- B.** Rear fog lamps

If front fog lamps are not fitted, the rear fog lamps will come on at position **A**.

Operating note

Fog lamps can not be operated if the lamps master switch is in **AUTO**.

Electric Parking Brake (EPB)

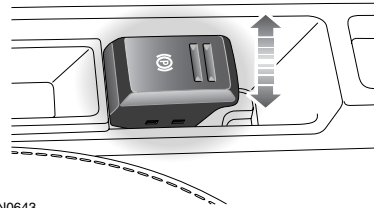

LAN0643

Applying

With the vehicle stationary, pull up the parking brake lever and then release it. The red warning indicator in the instrument panel will illuminate.

On manual transmission vehicles, the parking brake will automatically apply when the starter key is removed.

Releasing

The starter switch must be in position **I** or **II**. Apply the foot brake and press down on the parking brake lever.

On automatic transmission vehicles, if the vehicle is stationary with the parking brake applied and either **D** (Drive) or **R** (Reverse) selected, pressing the accelerator will automatically release the parkbrake.

Quick start

Automatic transmission

Gearshift interlock

The starter switch must be in position **II**, the foot brake applied and the selector release button pressed before the gear selector can be moved from **P** (Park) to **R** (Reverse).

The gear selector must be in the **P** position before the starter key can be removed.

Sport mode



LAN0644

In Sport mode, automatic gear changing is maintained but the gearshift changes are modified to improve performance. To select Sport mode, move the gear selector from the **D** position towards the left hand side of the vehicle.

The word **SPORT** will appear on the instrument pack display and the LED in the gear selector surround will illuminate.

When Sport is selected, the transmission will stay in lower gears for longer with downshifts occurring more readily. Fuel consumption will be adversely affected. If Terrain Response is fitted, Sport mode is only available when the **General** program is selected.

CommandShift™

CommandShift gear selection can be used as an alternative to automatic gear selection and is particularly effective when rapid acceleration or engine braking are required.

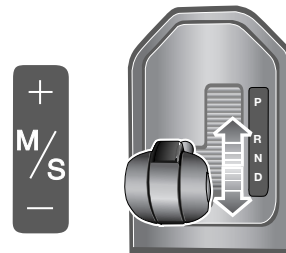

LAN0645

1. Select Sport mode. The transmission will automatically select the gear most appropriate to the vehicle's road speed and accelerator position.
2. Moving the selector lever forward (+) or backward (-) and then releasing will manually select a higher or lower gear (when available). The message **TRANSMISSION COMMANDSHIFT SELECTED** will appear in the message centre.
3. Subsequent gear selections will display the selected gear on the instrument pack display.
4. To deselect CommandShift mode, move the selector lever back to the **D** position.

Quick start

Transfer gearbox

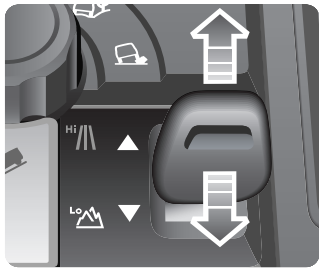

LAN0646

 **HIGH** range should be used for all normal road driving and also for off-road driving across dry level terrain.

 **LOW** range should be used in situations where low speed manoeuvring is necessary, or in extreme off-road conditions.

Range changing

The recommended method for range changing is with the vehicle stationary. With the engine running, and the main gearbox in **N** (Neutral), move the transfer gearbox lever to the required position and then release. The indicators on the switch and instrument pack display will flash during range changing. When range changing is complete a chime will sound and a message will be displayed on the message centre.

Hill Descent Control (HDC)

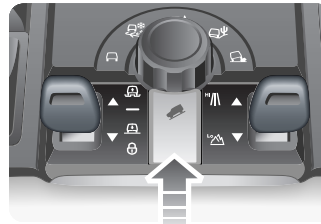

LAN0649

HDC operates in conjunction with the anti-lock braking system to provide greater control in off-road situations particularly when descending severe gradients.

 Press the switch (arrowed in illustration) to select HDC. HDC can be selected at speeds below 80 km/h (50 mph) but will not be fully active until the vehicle speed reduces below 50 km/h (30 mph), confirmed by a continuously illuminated HDC indicator in the instrument pack. Press the switch again to deselect HDC.

Quick start

Air suspension

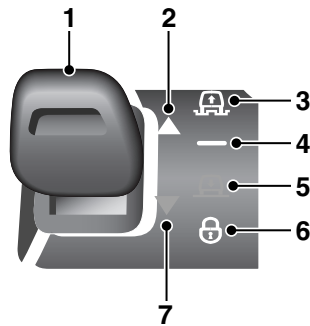

LAN0650

Vehicle height can be manually adjusted via the raise/lower lever **1**. Height changes may only be made when the engine is running and the driver and passenger doors are closed.

Indicators **2** or **7** will illuminate to show the direction of movement. They extinguish when the height change movement is completed.

Off-road height **3**, provides improved ground clearance and approach, departure and break-over angles.

On-road height **4**, is the normal height for the vehicle.

Access height **5**, lowers the vehicle to provide easier entry, exit and loading of the vehicle. This position may be selected up to 40 seconds after the starter switch is turned off.

Crawl (locked at Access height) **6**, allows the vehicle to be driven at low speeds at access height, to give increased roof clearance.

Vehicle height will be automatically adjusted according to road speed in order to maintain driveability and handling.
If Terrain Response is fitted, some of its programs will automatically adjust the suspension height.

Terrain response system



LAN0651

The Terrain Response system, if fitted, is always active and can not be switched off. When the vehicle is started the system will normally start in the **General** program.

Manual selection of a special program, by rotating the knob, will provide benefits in how the vehicle can be driven over different surfaces or terrains by automatically adjusting the vehicle's drive and suspension systems.

It is recommended that a special program be engaged whenever driving conditions could become difficult, and cancelled once the conditions for use are no longer present.

General



Suitable for surfaces that match typical road surfaces.

Grass-Gravel-Snow



Suitable for surfaces which are firm but have a slippery surface, e.g. grass, snow, loose gravel, pebbles or icy conditions.

Mud-Ruts



Suitable for soft, muddy, uneven or deeply rutted ground. It is recommended that LOW range is selected on the Transfer gearbox.

Quick start

Sand



Suitable for soft, predominantly dry, yielding sandy ground, e.g. sand dunes and deserts. If the sand is damp or wet, the Mud-Ruts program may be more beneficial.

Rock Crawl



Only selectable when the transfer gearbox is in LOW range. Suitable for crossing wet or dry, solid unyielding ground requiring high levels of wheel displacement, e.g. clusters of boulders or rocky river beds.

Wading

When driving through water less than 600 mm (24 inches) deep, select the program suitable for the surface beneath the water.

Cruise control

Cruise control enables the driver to maintain a constant road speed without using the accelerator pedal.

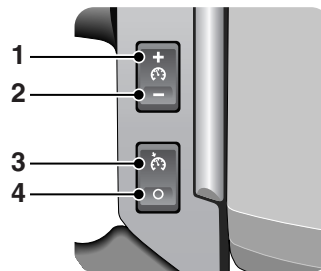

LAN0652

1. SET (+): to set a road speed or increase the speed in 2 km/h (1 mph) steps when cruise control is operating.
2. SET (-): to set a road speed or decrease the speed in 2 km/h (1 mph) steps when cruise control is operating.
3. RESUME: resumes a SET speed retained in memory.
4. CANCEL: cancel cruise control but retains the set speed in memory.

Cruise control will automatically **disengage** when the **brake/clutch pedal** is used or when the vehicle speed falls below 30 km/h (18 mph).

Quick start

Audio systems

General operation

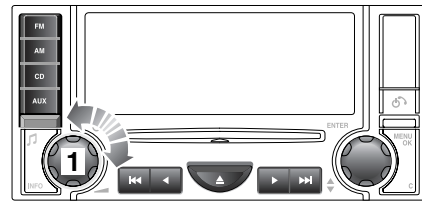

LAN0657

Press the knob **1** to switch on/off and rotate to adjust volume.

Press the appropriate mode button to select **FM, AM, CD** or **AUX**.

Press the **⏮** or **⏭** buttons to skip CD tracks or to search for a radio station. Press the **⏪** or **⏩** buttons to search through a CD track or to manually tune to a radio station.

Steering wheel controls

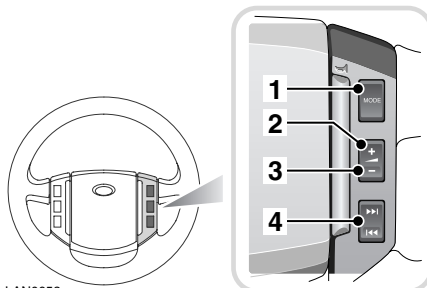

LAN0658

1. Press to switch between Radio, CD or AUX.
2. Press to increase volume.
3. Press to decrease volume.
4. Press and release to scroll through preset radio stations or CD tracks. Press and hold for two seconds to search up or down for the next or previous radio station/CD track.

Sound settings

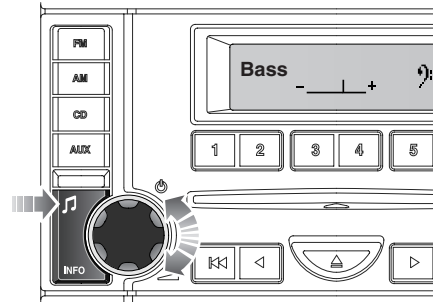

LAN0659

Press the **🎵** button repeatedly to scroll through the sound settings options. These options vary depending on specification of audio system, but will include: Bass, Treble, Balance, Fader and Reset Tone Settings.

Dependent upon audio system specification, other options may be available.

With the desired sound setting displayed, rotate **🔊** knob to adjust. Confirm new setting by pressing the **🎵** button.

Quick start

Radio operation

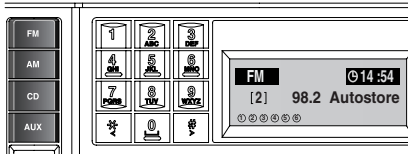

LAN0662

Press either the **FM** or **AM** button to select the required waveband. Repeated presses of either button will scroll through the FM and AM waveband memory options.

Storing radio stations

To automatically store radio stations, press and hold either the **FM** or **AM** button. **Autostore** will be shown on the information display and the stations will be stored under the preset numbers in the selected waveband.

To recall a preset station, press and release one of the numbered preset buttons. See **STATION PRESET BUTTONS** (page 292).

CD operation

Compatible disc types

The use of discs with paper labels or dual format discs (CD/DVD) should be avoided as they could become jammed.



LAN0664

Standard audio

The standard audio unit features a single-slot CD player.

Insert a disc, label side up, into the player. The disc will load and start to play.

To end CD playback, briefly press one of the other mode buttons (**FM**, **AM** or **AUX**).

To eject the disc, press the  button. The display will show the message **Remove Disc** when it is safe to do so.

Premium audio

The premium audio unit features an integral 6-disc autochanger.

Quick start

Loading CDs

To insert a single disc, press the **CD** button, then one of the number buttons **1-6**. When prompted by the information display, insert the disc, label side up. The autochanger will load the CD in the selected position.

To fully load the autochanger, press and hold the **CD** button. The information display will show **Loading All**. When prompted, insert a disc, label side up. This process is repeated until all six CD positions are occupied.

Playing CDs

When in CD mode, press the appropriate CD number **1-6** to start playing the selected disc. Playback commences and progresses sequentially through all of the loaded discs.

Playback can be paused by briefly pressing one of the other mode buttons (**FM**, **AM** or **AUX**). Playback will resume when the CD button is pressed again.

Ejecting CDs

To eject a single disc, select the required disc by pressing one of the number buttons **1-6** and then press the  button.

To eject all loaded discs, press and hold the  button, the discs will be ejected one at a time. Remove disc(s) only when the display shows the message **Remove Disc**.

Quick start

Navigation

The screen allows touch-control of the navigation system. Only a light touch is required to operate the function, excess pressure on the screen could result in damage. On initial activation, ensure that both the correct country and area have been selected.

Setting a destination

To set a destination and start using the navigation system, use the following procedure:

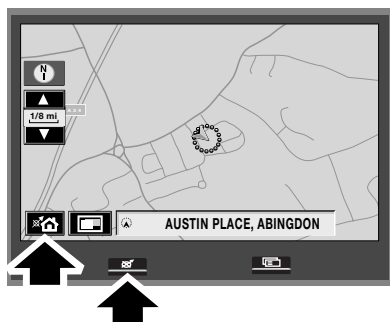

LAN0665

 Press the **Navigation** button on the display surround, and when prompted, touch **Agree** to access the initial Home menu.

 Touch the **Home** icon on the screen to access the navigation menu.

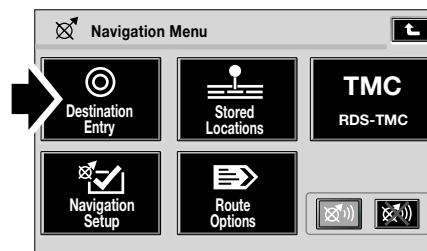

LAN0668

Touch the **Destination Entry** icon.

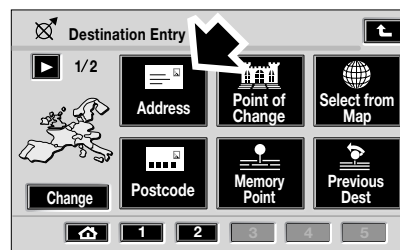

LAN0669

Touch the **Address** icon, then enter the **Town, Address and House Number** (if known) using the on-screen keypad.

Touch **OK** to enter.

Quick start

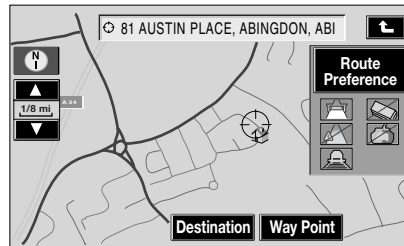

LAN0670

Once found, the screen displays the destination. To change the route settings, touch **Route Preference**, or touch **Destination** to start the route calculation.

Route preferences

When set, route preferences are remembered and used for calculating all new routes. If you encounter problems with the type of routes being selected or the guidance being given, please check the route preferences.

Once calculated, the screen highlights the route. Touch **3-Routes** to select an alternate route, or touch **Start** to start navigation. Drive away, following the voice guidance.

 Touch the audible repeat icon to hear again the last voice instruction.

When your destination is reached, voice and visual confirmation is given.

Cancelling guidance

 Touch the **Home** icon, select **Route options**, **Cancel guidance** and touch **Confirm**.

Quick start

Telephone – Bluetooth system

Mobile phones with Bluetooth capability can communicate with the vehicle's inbuilt telephone feature.

Mobile phone compatibility

There are a number of mobile phones that have been tested for full functionality with the Land Rover system, however not all phones are compatible and some may only be partially compatible. For the latest list of compatible phones and software versions, please refer to www.ownerinfo.landrover.com. Alternatively consult your Dealer.

Pairing a handset to the vehicle's system

Prepare the mobile phone for pairing to the system. See the telephone manufacturer's instructions for further details, or follow the table below for generic commands.

When the handset has been successfully paired to the system, **Bluetooth** will appear on the Phone menu screen.

Note: *If more than one paired Bluetooth phone is in range, the system will automatically select the last phone used in Bluetooth mode.*



| | Nokia | Motorola | Ericsson |
|----|---|---|--|
| 1. | Select menu | Select menu | Select menu |
| 2. | Select settings | Select settings | Select connectivity |
| 3. | Select Bluetooth OR Select Connectivity then Bluetooth | Select Connection | Select Bluetooth |
| 4. | Select On | Select Bluetooth link | Select My Devices |
| 5. | Select Search for Audio devices | Select Hands-free | With New Device highlighted, select Add. Press OK to confirm |
| 6. | After search select Land Rover | Select Look for devices | After search select Land Rover |
| 7. | Enter pass code 2121. Press OK to confirm | After search select Land Rover | Select Connect |
| 8. | No connection? Select Bluetooth (Menu) then Paired devices Jaguar | Permission to bond? Select Yes and enter pass code 2121 | Enter pass code 2121 after prompt |

Quick start

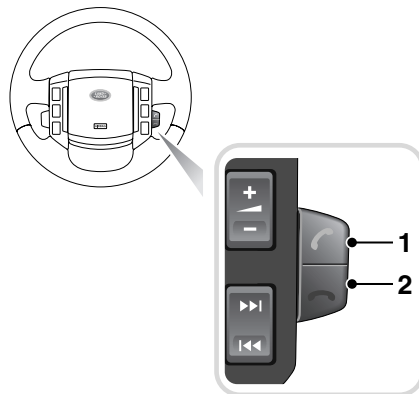
Making a call



LAN0673

1. With a paired or docked handset, press the  button on the audio system, or operate the answer call switch **1** on the steering wheel controls.
2. Enter the required telephone number using the numeric keypad.
3. Press the  button, or operate the answer call switch **1** on the steering wheel to send.

Receiving a call

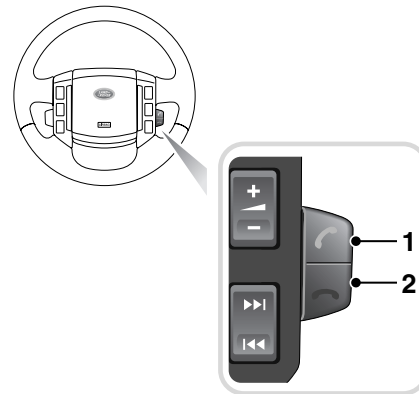

LAN0673

To answer an incoming call, press the  button on the audio unit, or operate the answer call switch **1** on the steering wheel controls.

To end, or reject an incoming call, press the **C** button on the audio system, or operate the end call switch **2** on the steering wheel.